

# MEETING MINUTES

**Date of Meeting:** 5/13/2021      **Re:** Leeper Park Michigan Street Bridge; SR  
933 over St. Joseph River (Des. No.  
1900011)

**Location:** Microsoft Teams      **Issue Date:** 6/3/21

**Submitted By:** Ruth Hook

**In Attendance:** Stakeholder Group  
Project Sponsor (INDOT)  
Lochmueller Group  
(Full List of Attendees Attached)

## ITEMS DISCUSSED:

### I. Introductions

- a. Ruth Hook from Lochmueller Group went through and identified those on the call, their agency, and their roll. A full list of those in attendance can be found attached to these meeting minutes. Two invited stakeholders who expressed interest in participating in the process were not able to attend the first meeting.
- b. A complete list of those invited to participate in the stakeholder process is also attached to these minutes. Lochmueller Group will follow up with those who did not respond to the initial invitation.

### II. Why are we here?

- a. Ruth Hook from Lochmueller Group went through the purpose of a Stakeholder Group, the meeting agenda, and the goals for the meeting.

### III. History of the Bridge and Project

- a. Michael Vereb from Lochmueller Group went through a history of the structure, the timeline of previous structure rehabilitations and the current condition of the structure.

### IV. Purpose and Need

- a. Ruth Hook from Lochmueller Group walked through an abbreviated version of the Purpose and Need statement for the project to familiarize the stakeholder group with what the project is working towards accomplishing and why.

### V. Proposed Alternatives

- a. A – No Build
- b. B1a - Rehabilitation including arch & foundation rehabilitation

- i. The life span of Alternative B1a was identified as being less than B1b due to the work proposed with this alternative not resulting in the improvement of all structure components.

c. B1b - Rehabilitation including arch & foundation replacement

**VI. Project Name and Logos**

a. Survey Link: <https://www.surveymonkey.com/r/FCZNPY2>

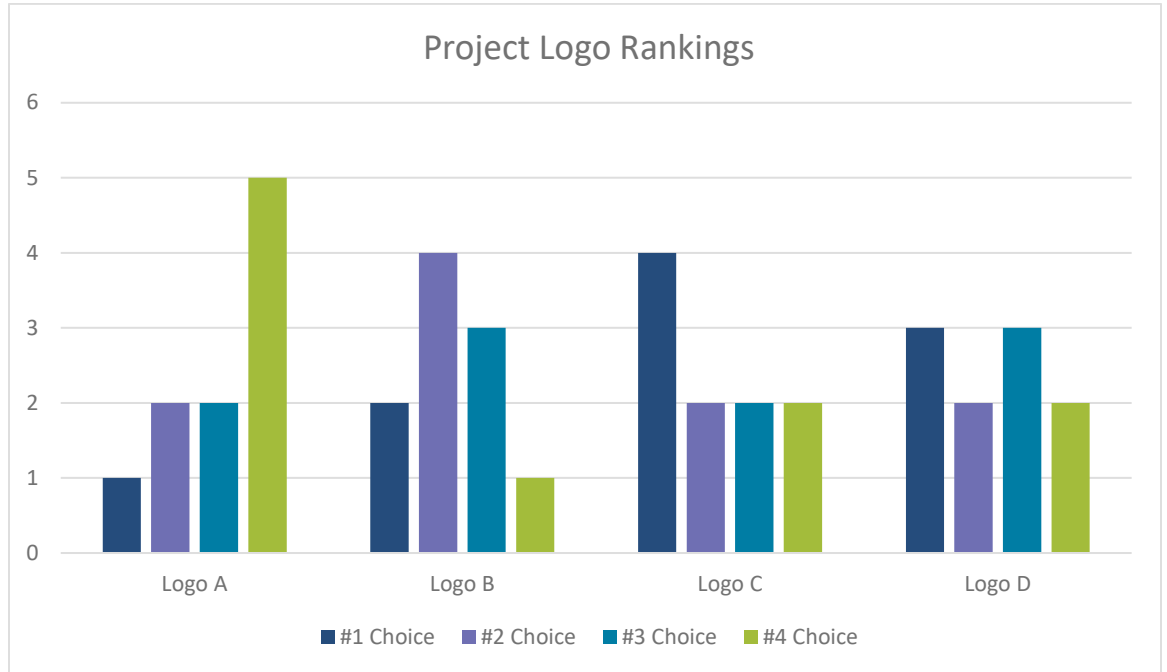

- i. 10 people responded to survey.
- ii. Logo C was the top choice of respondents.
- iii. The survey remains open and others can cast their vote through 6/11/2021

**Logos:**





D.

**VII. Areas of Interest**

a. Survey Link: <https://www.surveymonkey.com/r/N3Y537X>

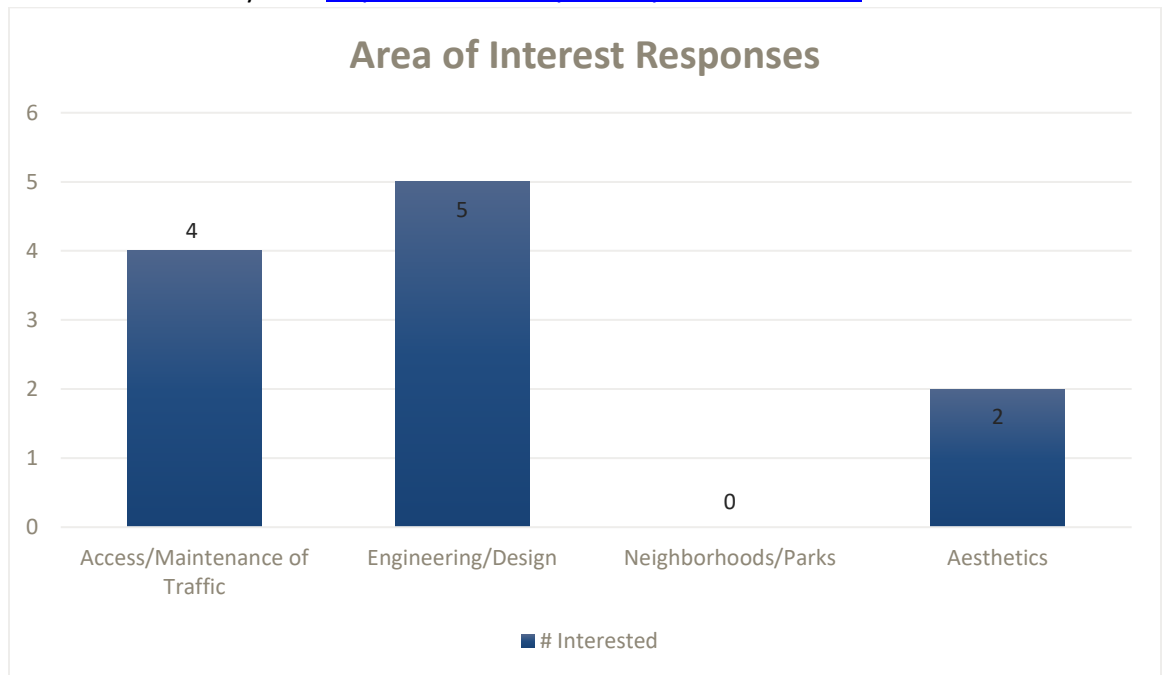

- i. These areas of interest will be used to facilitate future discussions with the stakeholder group
- ii. The survey remains open and others can cast their vote through 6/11/2021

**VIII. Discussion and Questions**

- a. Maintenance of Traffic/Access: It was identified that access and maintenance of traffic is a public safety concern and of great interest to the group.
  - i. Memorial Hospital is the only Level 2 hospital within 90 miles and any delays in emergency services reaching the hospital could be problematic.
  - ii. It was discussed that Alternative B1a has the opportunity to maintain traffic on the structure while Alternative B1b may require the closure of the structure.
  - iii. It was discussed that the Maintenance of Traffic has not yet been decided and input from stakeholders is important.
  - iv. It is anticipated that this will be a 2 year construction period

June 3, 2021

Page 4

- b. An option to flatten the vertical curves of the arches in the structure was brought up
  - i. This is a possible option; however, it is not being considered as part of this project as it would change the look of the structure and make reinstallation of the limestone fascia not possible.
- c. It was discussed that both Alternatives B1a and B1b would involve the widening of the east sidewalk to meet current ADA standards. How this will be accomplished is being identified as part of the Historic Bridge Alternatives Analysis (HBAA) which is on-going.
- d. The cost of the project was brought up. The HBAA will identify the costs associated with each Alternative. The HBAA will also include the cost for the Maintenance of Traffic.

---

The above constitutes our understanding of the meeting. If you believe there are omissions, additions, or corrections, please send your written comments within seven working days to Lochmueller Group.

---



**Leeper Park Michigan Street Bridge  
Stakeholder Group Meeting #1 Sign IN sheet**

First Name	Last Name	Title	Agency	Email	Mtg #1
Ruth	Hook	Environmental Lead	Lochmueller Group	<a href="mailto:rhook@lochgroup.com">rhook@lochgroup.com</a>	X
Susan	Al Abbas	Regional Manager	Lochmueller Group	<a href="mailto:salabbas@lochgroup.com">salabbas@lochgroup.com</a>	X
Michael	Vereb	Project Manager	Lochmueller Group	<a href="mailto:mvereb@lochgroup.com">mvereb@lochgroup.com</a>	X
Larry	Tracy	President	Beacon Health Systems - Memorial Hospital of South Bend	<a href="mailto:ltracy@beaconhealthsystem.org">ltracy@beaconhealthsystem.org</a>	X
Kara	Boyles	City Engineer	Engineering - City of South Bend	<a href="mailto:kboyles@southbendin.gov">kboyles@southbendin.gov</a>	X
Kyle	Silveus	Engineer	Engineering - City of South Bend	<a href="mailto:ksilveus@southbendin.gov">ksilveus@southbendin.gov</a>	X
Adam	Toering	Historic Preservation Specialist	Historic Preservation Commission of South Bend & St. Joseph County	<a href="mailto:atoering@southbendin.gov">atoering@southbendin.gov</a>	X
Eric	Horvath	Executive Director	Department of Public Works - City of South Bend	<a href="mailto:ehorvath@southbendin.gov">ehorvath@southbendin.gov</a>	X
Jeff	Rea	President & CEO	Chamber of Commerce	<a href="mailto:jrea@sbrchamber.com">jrea@sbrchamber.com</a>	N/A
John	Krueckeberg	Project Manager	INDOT LaPorte District	<a href="mailto:jkrueckeberg@indot.in.gov">jkrueckeberg@indot.in.gov</a>	X
Mark	Pittman	Bridge Asset Engineer	INDOT LaPorte District	<a href="mailto:mapittman@indot.in.gov">mapittman@indot.in.gov</a>	X
Steve	Benczik	System Asset Engineer	INDOT LaPorte District	<a href="mailto:stbenczik@indot.in.gov">stbenczik@indot.in.gov</a>	X
Stew	Michels	Enviromental Manager	INDOT LaPorte District	<a href="mailto:smichels@indot.in.gov">smichels@indot.in.gov</a>	X
Steve	Hauersperger	Area Engineer	INDOT LaPorte District	<a href="mailto:shauersperger@indot.in.gov">shauersperger@indot.in.gov</a>	X
Adam	Parkhouse	Communications Director	INDOT LaPorte District	<a href="mailto:aparkhouse@indot.in.gov">aparkhouse@indot.in.gov</a>	X
Lisa	Shrader	Consultant Services Manager	INDOT LaPorte District	<a href="mailto:lshrader@indot.in.gov">lshrader@indot.in.gov</a>	N/A
Amy	Stanley	Customer Service Manager	INDOT LaPorte District	<a href="mailto:astanley@indot.in.gov">astanley@indot.in.gov</a>	X
Ron	Bales	Environmental Policy Manager	INDOT Environmental Services	<a href="mailto:rbales@indot.in.gov">rbales@indot.in.gov</a>	X
Mary	Kennedy	Historic Bridge Specialist	INDOT Environmental Services	<a href="mailto:mkenedy@indot.in.gov">mkenedy@indot.in.gov</a>	X
Kelyn	Alexander	Historian	INDOT Environmental Services	<a href="mailto:kalexander3@indot.in.gov">kalexander3@indot.in.gov</a>	X
Mahmoud	Hailat	Team Leader - Bridge Engineering	INDOT Bridge Design, Inspection, & Hydraulics	<a href="mailto:MHailat@indot.IN.gov">MHailat@indot.IN.gov</a>	
Greg	Klevitsky	Bridge Engineer	INDOT Bridge Design, Inspection, & Hydraulics	<a href="mailto:gklevitsky@indot.in.gov">gklevitsky@indot.in.gov</a>	X
Martha	Chernet	Bridge Engineer	INDOT Bridge Design, Inspection, & Hydraulics	<a href="mailto:mchernet@indot.in.gov">mchernet@indot.in.gov</a>	
Brandon	Miller	Environmental Manager	INDOT Environmental Services	<a href="mailto:bramiller1@indot.in.gov">bramiller1@indot.in.gov</a>	X
Leslie	Biek	Engineer	Engineering - City of South Bend	<a href="mailto:lbiek@southbendin.gov">lbiek@southbendin.gov</a>	X
Brian	Arterbery	Roadway Lead	Lochmueller Group	<a href="mailto:barterbery@lochgroup.com">barterbery@lochgroup.com</a>	X

**Leeper Historic Bridge Project**  
Stakeholder List

First Tier	First Name	Last Name	Title	Address	Phone	Email	Response
Near Northwest Neighborhood Association	Kathy	Schuth	Executive Director	1007 Portage Avenue, South Bend, IN 46617	574-232-9182	nnndirector@nearnorthwest.org	
Beacon Health Systems	Kreg	Gruber	CEO	615 N Michigan St, South Bend, IN 46601	574-647-1000	KGruber@beaconhealthsystem.org	No - sending proxy below
Beacon Health Systems - South Bend Hospital	Larry	Tracy	President			ltracy@beaconhealthsystem.org	Yes
South Bend Community School Corporation	Dr. C. Todd	Cummings	Superintendent	215 South Dr. Martin Luther King Jr. Blvd., South Bend, IN 46601	574-393-6129	ctoddcumings@sbcsc.k12.in.us	
Emergency Management Agency	Kalee	Foreman	Deputy Director	1222 South Michigan. South Bend, Indiana 46601	574-235-9378	kforeman@sjcindiana.com	
Engineering - City of South Bend	Kara	Boyles	City Engineer	227 West Jefferson Blvd. South Bend, Indiana 46601	574-233-0311	kboyles@southbendin.gov	Yes
Venues Parks & Arts - City of South Bend	Aaron	Perri	Executive Director	219 S. St. Louis Blvd. South Bend, IN 46617	574-299-4765	aperri@southbendin.gov	
St. Joseph County	Sky	Medors	County Engineer	227 W. Jefferson Boulevard County-City Building, Room 732 South Bend, IN 46601	574-235-9626	smedors@sjcindiana.com	
University of Notre Dame	Paul	Browne	Vice President for Public Affairs and Communications	405 Main Building, Notre Dame, IN 46556	574-631-6798	pbrowne@nd.edu	No
Mayors Office - City of South Bend	James	Mueller	Mayor	227 W Jefferson Blvd Suite 1400 N South Bend, IN 46601	574.233.0311	mayormueller@southbendin.gov	
Historic Preservation Commission of South Bend & St. Joseph County	Adam	Toering	Historic Preservation Sp	227 W. Jefferson Blvd., Ste. 1400, South Bend, IN 46601	(574) 235-7672	atoering@southbendin.gov	Yes
Department of Public Works - City of South Bend	Eric	Horvath	Executive Director	227 West Jefferson Blvd. South Bend, Indiana 46601	574-233-0311	ehorvath@southbendin.gov	Yes
Water Works - City of South Bend	Ken	Smith				ksmith@southbendin.gov	
Mayors Office - City of South Bend	Caleb	Bauer	Director of Communicat	227 W Jefferson Blvd Suite 1400 N South Bend, IN 46601		cbauer@southbendin.gov	
Transpo	Amy	Hill	CEO & General Manager	1401 South Lafayette Boulevardm, South Bend, IN 46613	574-239-2305		
University of Notre Dame	Tim	Sexton	Associate Vice President	405 Main Building, Norte Dame, IN 46556	574-631-1099	Timothy.D.Sexton.30@nd.edu	No
Northshore Triangle Neighborhood Group	Barb	Sutton	President	528 Ostemo Pl, South Bend, IN 46617			
Engineering - City of South Bend	Kyle	Silveus				ksilveus@southbendin.gov	Yes
Second Tier	First Name	Last Name	Title	Address	Phone	Email	Response
Chamber of Commerce	Jeff	Rea	President and CEO	101 N. Michigan St. Suite 300 South Bend, IN 46601	574-400-4000	jrea@sbrchamber.com	yes, unable to attend first meeting
City of South Bend Police Department			Public Information Officer	701 W Sample St, South Bend, IN 46601	574-235-9201	sbpd@southbendin.gov	
South Bend Heritage Foundation	Marco	Mariani	Executive Director	803 Lincoln Way W, South Bend, IN 46616	574-289-1066	MarcoMariani@sbheritage.org	
Downtown South Bend	Courtney	Quinlan	Director of Communicat	217 South Michigan Street, South Bend, IN 46601	574-282-1110	cquinlan@downtownsouthbend.com	
Project Team Members	First Name	Last Name	Title	Address	Phone	Email	Response
INDOT LaPorte District	John	Krueckeberg	Project Manager		219-325-7520	Jkrueckeberg@indot.in.gov	Yes
INDOT LaPorte District	Mark	Pittman	Bridge Asset Engineer		219-325-7533	mapittman@indot.in.gov	Yes
INDOT LaPorte District	Paul	South	Scoping Manager		219-325-7540	psouth@indot.in.gov	
INDOT LaPorte District	Steve	Benczik	System Asset Manager		219-325-7519	stbenczik@indot.in.gov	Yes
INDOT LaPorte District	Sarah	Ford	Technical Services Director		219-325-7506	sford@indot.in.gov	No
INDOT LaPorte District	Stew	Michels	Environmental Manager		219-325-7560	smichels@indot.in.gov	Yes
INDOT LaPorte District	Steven	Travis	Railroad/Utilities Engineer		219-325-7486	stravis2@indot.in.gov	
INDOT Environmental Services	Mary	Kennedy	Historic Bridge Specialist		317-694-3607	mkennedy@indot.in.gov	Yes
INDOT LaPorte District	Steve	Hauersperger	Area Engineer		219-325-7535	shauersperger@indot.in.gov	Yes
INDOT Bridge Design, Inspection, and Hydraulics	Greg	Klevitsky	Bridge Engineer		317-233-5569	gklevitsky@indot.in.gov	Yes
INDOT LaPorte District	Adam	Parkhouse	Communications Director		219-325-7526	aparkhouse@indot.in.gov	Yes
INDOT LaPorte District	Lisa	Shrader	Consultant Services Manager		219-325-7522	lshrader@indot.in.gov	Yes, unable to attend first meeting
INDOT LaPorte District	Amy	Stanley	Customer Service Manager		219-325-7475	astanley@indot.in.gov	Yes
INDOT LaPorte District	Cassy	Bajek	Public Relations Director		219-851-1251	cbajek@indot.in.gov	No
Federal Highway Administration	Kari	Carmany-George	Planning and Environmental Specialist		317-226-5629	k.carmanygeorge@dot.gov	No
INDOT Environmental Services	Ron	Bales	Environmental Policy Manager		317-515-7908	rbales@indot.in.gov	Yes
INDOT Bridge Design, Inspection, and Hydraulics	Mahmoud	Hailat	Team Leader - Bridge Engineering		317-234-5299	MHailat@indot.IN.gov	Yes
INDOT Environmental Services	Kelyn	Alexander	Historian			kalexander3@indot.in.gov	Yes
INDOT Bridge Design, Inspection, and Hydraulics	Martha	Chernet	Bridge Engineer			mchernet@indot.in.gov	Tenative

# LEEPER PARK MICHIGAN STREET BRIDGE STAKEHOLDER MEETING



DES. NO. 1900011; STATE ROAD (SR) 933 OVER ST. JOSEPH RIVER



1

## Meeting Agenda

- Introductions
- Why are we here?
- History of the Bridge & Project
- Purpose & Need
- Proposed Alternatives
- Project Name & Logos
- Areas of Interest
- Discussion & Questions



2



# Introductions

## Lochmueller Project Team

- Susan Al Abbas, Regional Manager
- Michael Vereb, Project Manager
- Ruth Hook, Environmental Lead

## Stakeholder Group Members

- Larry Tracy, Beacon Health Systems
- Kara Boyles, Engineering – City of South Bend
- Kyle Silveus, Engineering – City of South Bend
- Adam Toering, Historic Preservation Commission of South Bend & St. Joseph County
- Eric Horvath, Department of Public Works – City of South Bend
- Jeff Rea, Chamber of Commerce

## Project Sponsor

- **INDOT LaPorte District**
  - John Krueckeberg, Project Manager
  - Mark Pittman, Bridge Asset Engineer
  - Steve Benczik, System Asset Manager
  - Stew Michels, Environmental Manager
  - Steve Hauersperger, Area Engineer
  - Adam Parkhouse, Communications Director
  - Lisa Shrader, Consultant Services Manager
  - Amy Stanley, Customer Service Manager
- **INDOT Environmental Services**
  - Ron Bales, Environmental Policy Manager
  - Mary Kennedy, Historic Bridge Specialist
  - Kelyn Alexander, Historian
- **INDOT Bridge Design, Inspection, & Hydraulics**
  - Mahmoud Hailat, Team Leader – Bridge Engineering
  - Greg Klevitsky, Bridge Engineer
  - Martha Chernet, Bridge Engineer



3



4

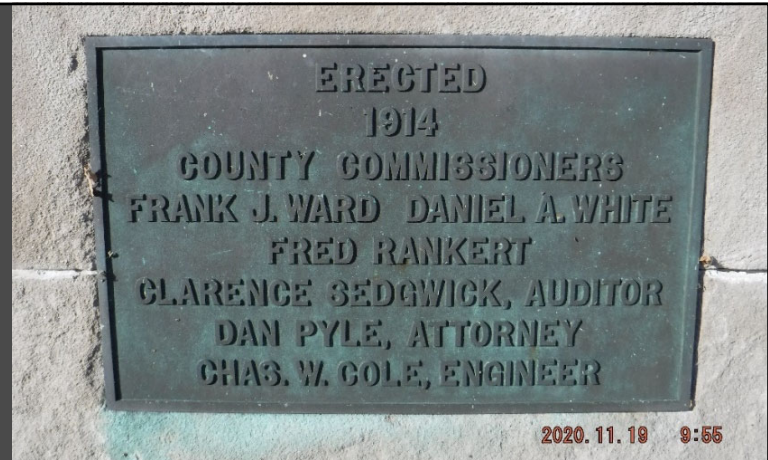

ERECTED  
 1914  
 COUNTY COMMISSIONERS  
 FRANK J. WARD DANIEL A. WHITE  
 FRED RANKERT  
 CLARENCE SEDGWICK, AUDITOR  
 DAN PYLE, ATTORNEY  
 CHAS. W. COLE, ENGINEER

2020.11.19 9:55



# Leeper Park Michigan Street Bridge



5

# Historic Bridge Photos



1919

South Bend Tribune



1936

South Bend Tribune



1958

South Bend Tribune



2006



2021



6



# Rehabilitation Timeline

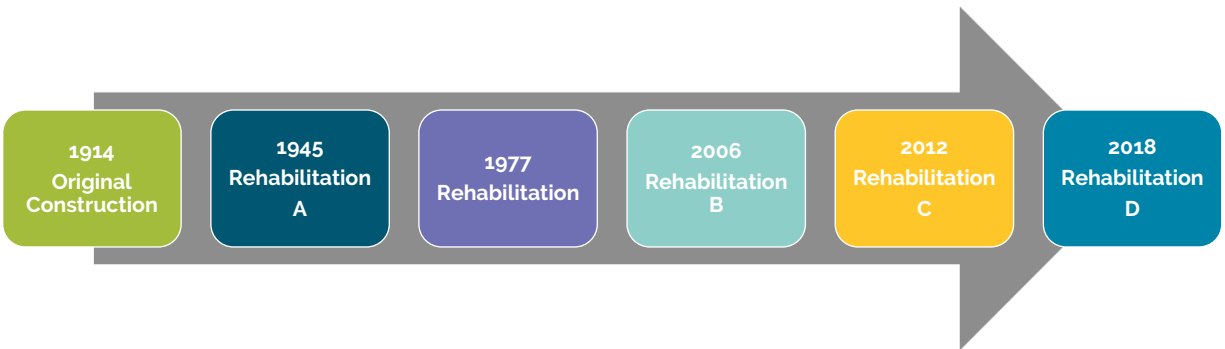

7

# Railing Cracking & Coping Deflection Signs of Structural Problems



8

# 1994 Underwater Inspection – Scour Discovered

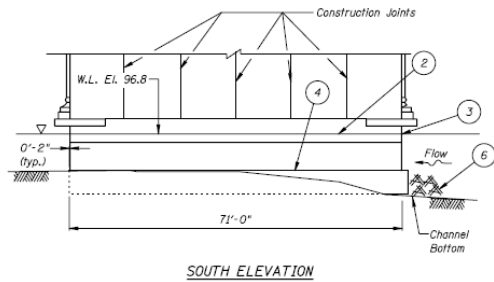

Scour at Pier #3



9

# Routine & Underwater Inspections Discover Arch & Pier Displacement

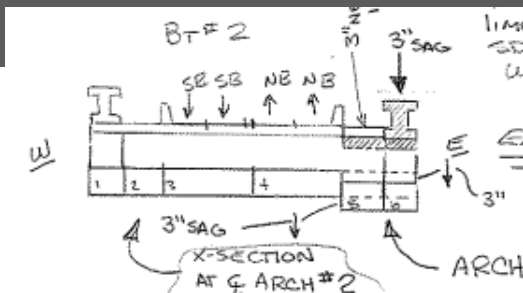

Arch Displaced & Large Cracks in Limestone  
1998 Routine Inspection

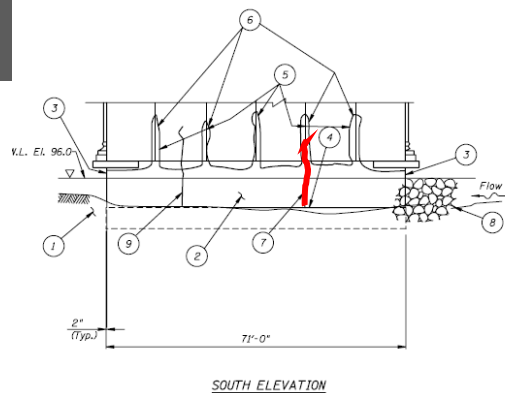

Scour & Vertical Crack at Pier #3  
2003 Underwater Inspection



10

# Arch & Pier Segment Displacement

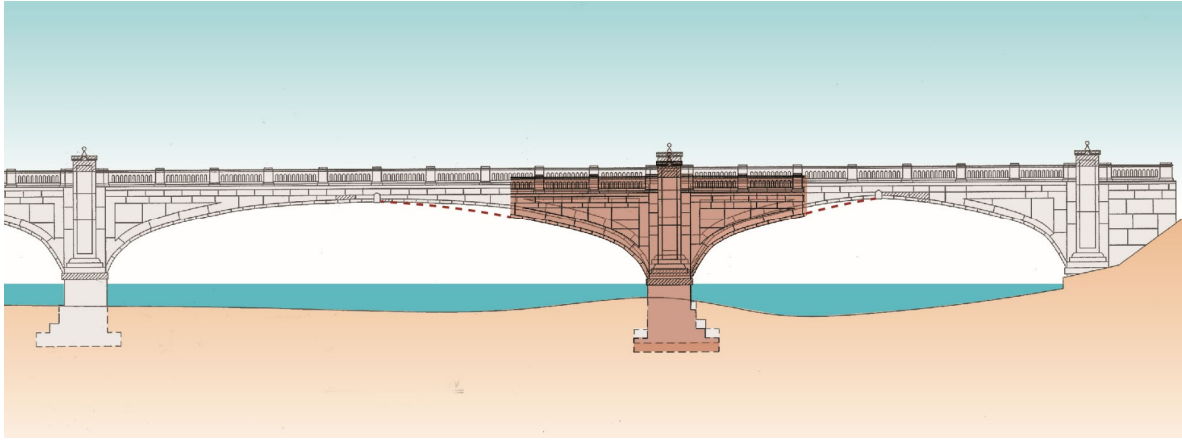

11

# Arch Segment Displacement Today



12



# 2006 Rehabilitation – Addition of Cofferdam

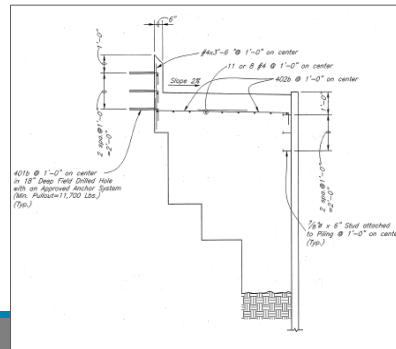
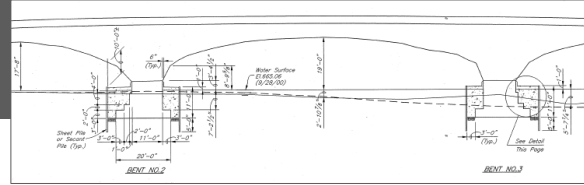

13

# 2012 Rehabilitation – Transverse Cracking

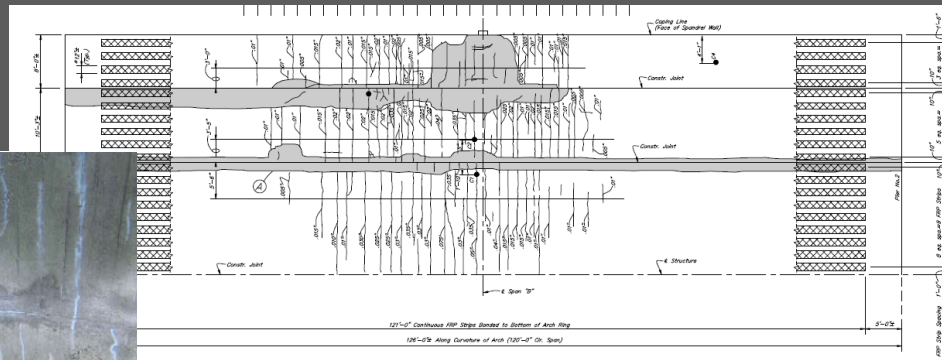

14

# 2012 Arch Repair & Strengthening with Fiber Reinforced Polymer (FRP)



15

# Limestone Condition – Railing Posts



16

## Limestone Condition – Spandrel Wall Fascia



Typical Crack



Typical Spall



17

## Purpose and Need

The primary need for the Leeper Park Michigan Street Bridge project is evidenced by the deteriorated condition and insufficient load capacity of the bridge. In addition, the sidewalk on the east side of the bridge does not meet current Americans with Disabilities Act (ADA) standards.

The purpose of the project is to provide a crossing of the St. Joseph River that has a condition rating of at least 7 out of 9, which is considered to be in "good" condition, as well as provide ADA-compliant pedestrian facilities. In addition, the purpose of the project will improve the load rating factor. This project will extend the life of this crossing for a minimum of 25 years.



18



# Proposed Alternatives

A - No Build



19

## Proposed Alternatives – B1a Removal

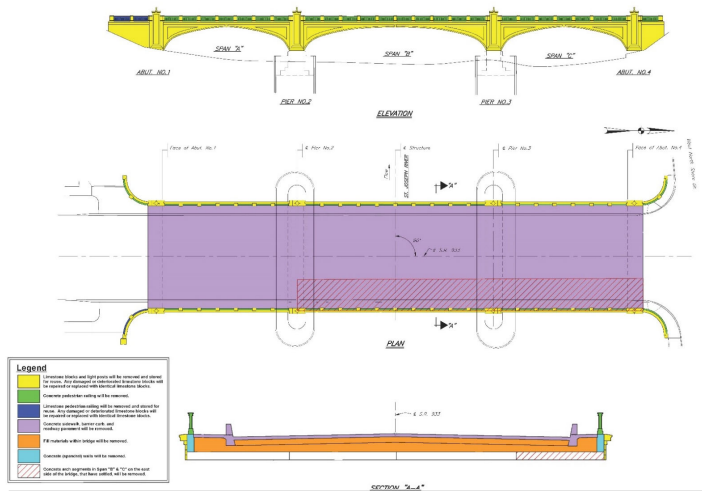

B1a. Rehabilitation including arch & foundation rehabilitation



20



# Proposed Alternatives – B1a Reconstruction

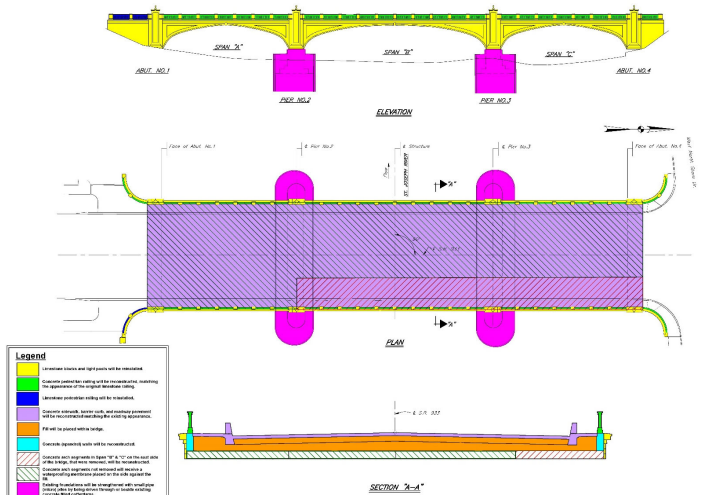

B1a. Rehabilitation including arch & foundation rehabilitation



# Proposed Alternatives – B1b Removal

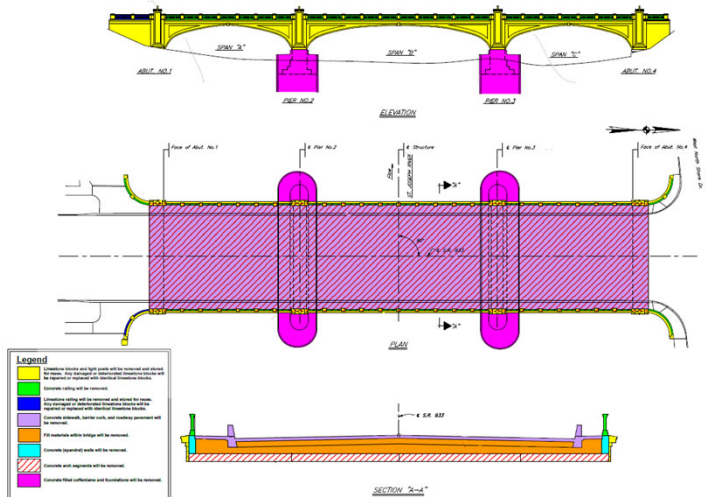

B1b. Rehabilitation including arch & foundation replacement



# Proposed Alternatives – B1b Reconstruction

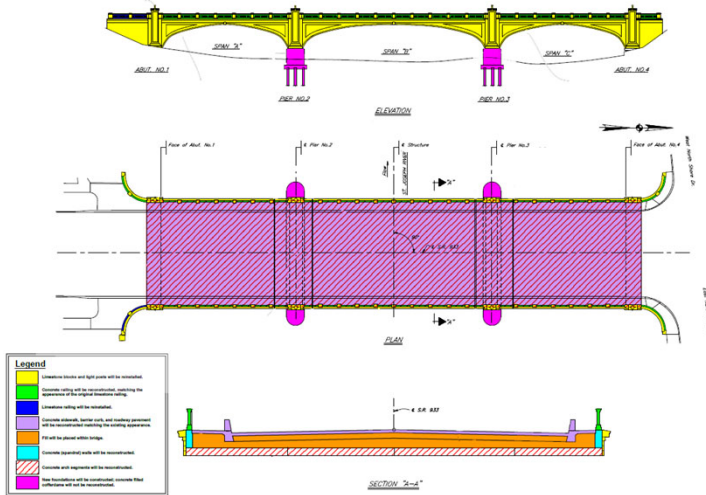

**B1b. Rehabilitation including arch & foundation replacement**



# Proposed Alternatives

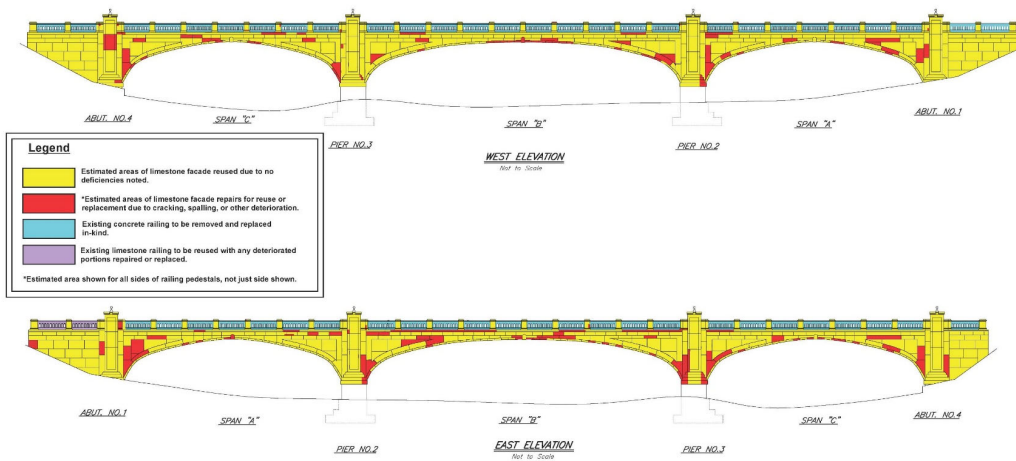

**Limestone Condition & Recommendations**



# Remaining Limestone Railing Panels



25

# Project Name and Logos



A.

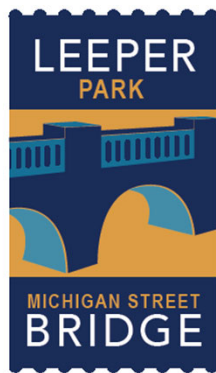

B.



C.



D.



26



## Areas of Interest

- Access/Maintenance of Traffic
- Engineering/Design
- Neighborhoods/Parks
- Aesthetics
- Other?



27



## Discussion & Questions



28